

# RIVERFRONT PLACE



FOR LEASE

**Restaurant/Retail  
Space**



**COLDWELL BANKER  
COMMERCIAL**  
KENNON, PARKER,  
DUNCAN & DAVIS

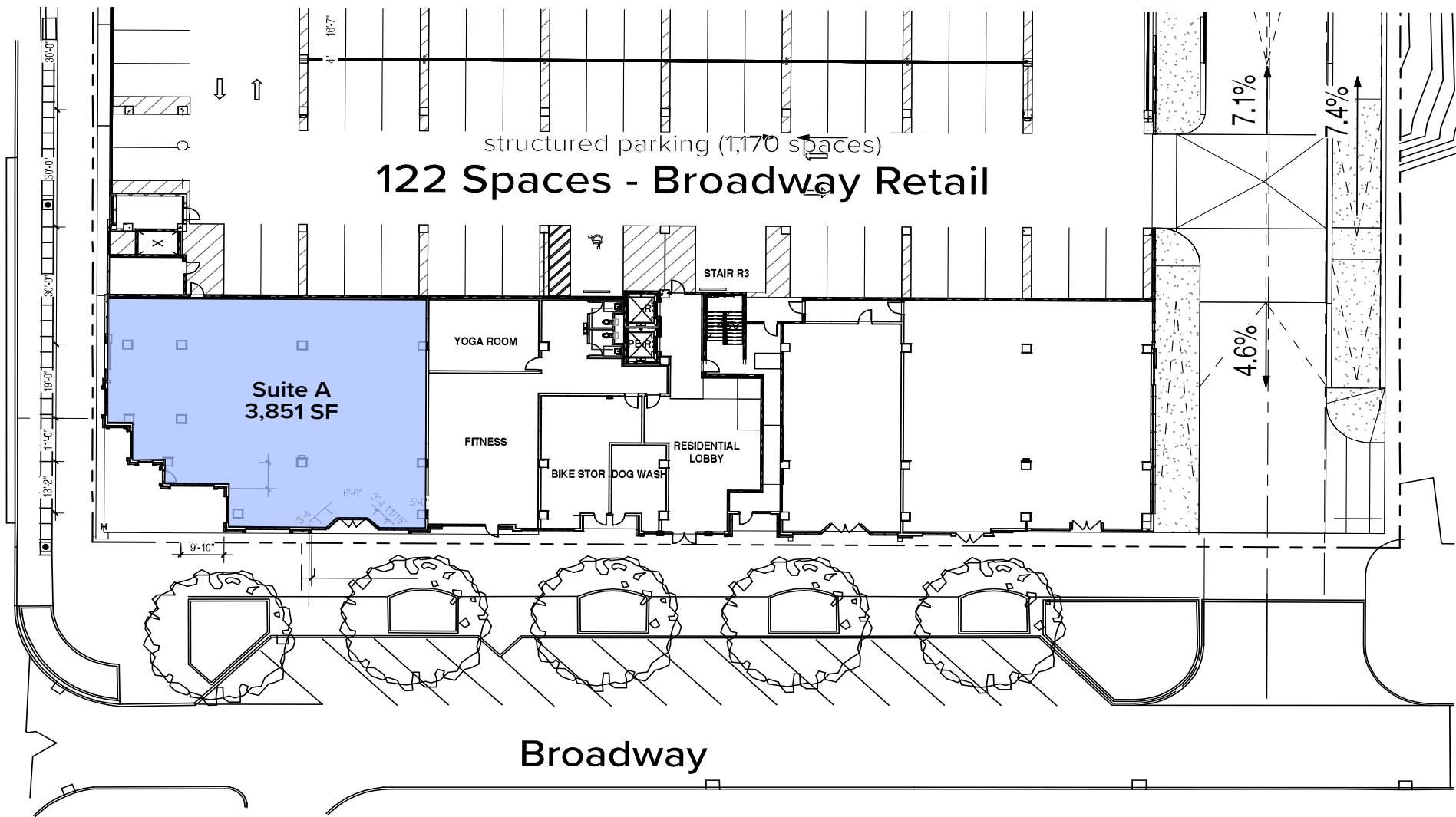

#### DAILY POPULATION

Located adjacent to the new Synovus Corporate Headquarters and its 900+ local employees, and steps away from Global Payments - Columbus Campus and its 2,500+ local employees



#### PARKING

On-site parking structure with over 1,150 spaces and 120+ spaces immediately adjacent to the retail spaces. Additionally over 50 parking spaces on the street directly in front of retail space.



#### OUTSIDE AMENITIES

Pedestrian friendly amenities with features like adjacent Mat Swift Park, steps away from the RushSouth Whitewater Park and 22.6 mile DragonFly Trail.



#### IMMEDIATE POPULATION

452 luxury apartments located on-site with over 330 hotel rooms and 90 luxury condominiums within 1 block. Additionally, Columbus State University and over 2,500 students located within 2 blocks of development.

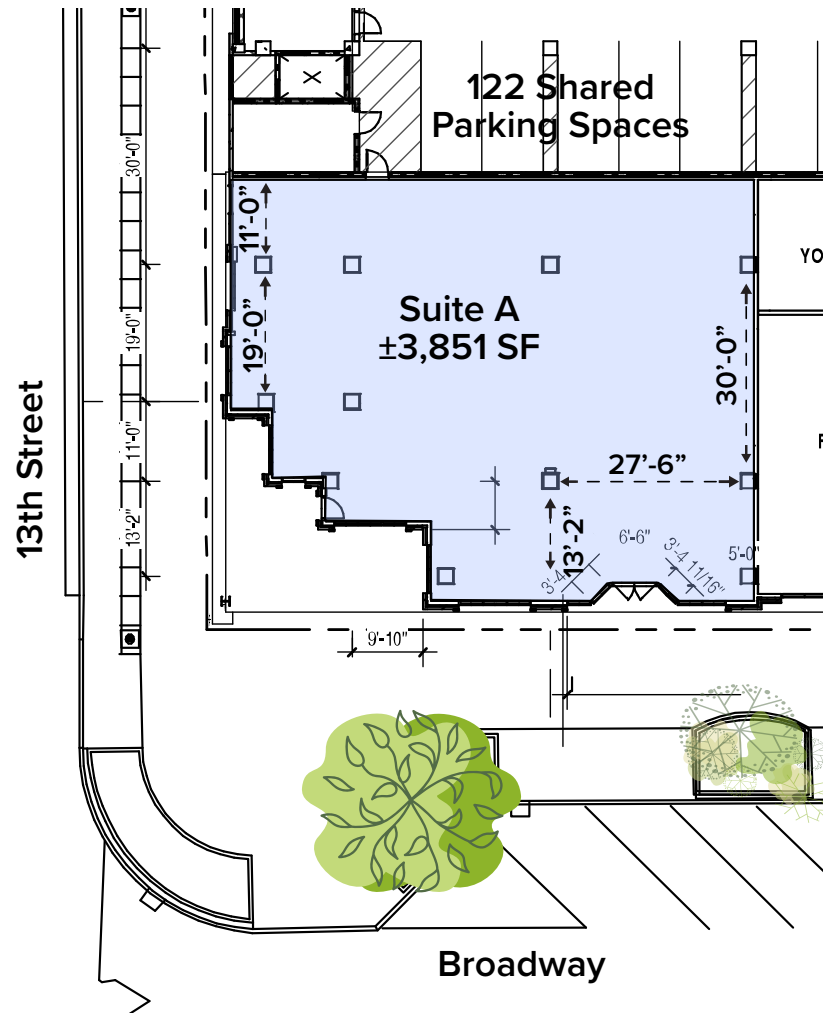

## Suite A

±3,851 SF

RIVERFRONT  
PLACE





# RIVERFRONT PLACE





# RIVERFRONT PLACE





# RIVERFRONT PLACE

6 Riverfront Place - Restaurant / Retail Space



**COLDWELL BANKER  
COMMERCIAL**  
KENNON, PARKER,  
DUNCAN & DAVIS



## Leasing Contact:

### Ed Adams, CCIM

Commercial Sales & Leasing  
Coldwell Banker Commercial - KPDD  
T: 706.577.9872  
ed@edadamscre.com

### Carson Cummings

Commercial Sales & Leasing  
Coldwell Banker Commercial - KPDD  
T: 706.289.2468  
carson@cbckpdd.com

### Tripp Crawford

Commercial Sales & Leasing  
Coldwell Banker Commercial - KPDD  
T: 706.984.1251  
tripp@cbckpdd.com

# RIVERFRONT PLACE